

I.D. Pipe

ASTM A 778

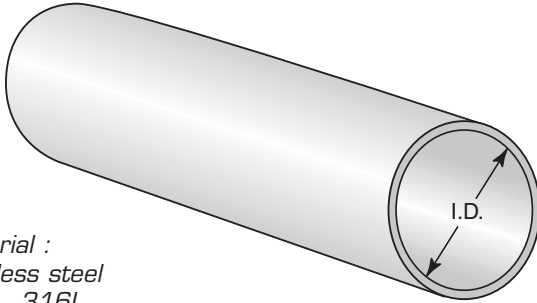

Material :
stainless steel
304L, 316L.

Other alloys available
on request.

Wall thickness tolerance
according to
ASTM A 778.

Available in 20 foot
lengths.

Approximate weight (lbs/foot - kilos/meter)

Inside Diameter		Gauge 14		12		11		10		3/16"		1/4"	
inches	mm	lbs/ft	kgs/m	lbs/ft	kgs/m	lbs/ft	kgs/m	lbs/ft	kgs/m	lbs/ft	kgs/m	lbs/ft	kgs/m
3	76.2	2.6	3.9	3.7	5.5	4.2	6.3						
4	101.6	3.5	5.2	4.9	26.9	5.6	8.4						
5	127.0	4.4	6.6	6.1	9.1	7.0	10.5						
6	152.4	5.2	7.8	7.3	10.9	8.4	12.6						
8	203.2	7.1	10.6	9.9	14.8	11.2	16.8						
10	254.0	8.6	12.9	12.2	18.3	14.0	21.0						
12	304.8	10.4	15.6	14.7	22.0	16.8	25.2						
14	355.6			17.2	25.8	19.6	29.4	21.8	32.7	31.2	46.8		
16	406.4					22.2	33.3	25.0	37.5	35.6	53.4		
18	457.2					24.8	37.2	28.1	42.1	36.5	56.6	52.1	78.1
20	508.0					27.8	41.7	31.3	46.9	40.6	63.0	57.9	86.8
24	609.6					33.2	49.8	37.5	56.2	49.0	73.5	69.6	104.4
30	762.0					41.7	62.5			68.7	103.0	84.0	126.0
36	914.4					49.4	74.1			82.0	123.0	106.0	159.0

- Other diameters and thicknesses available on request.
- Refer to technical section for maximum working pressure.

ASTM A 774

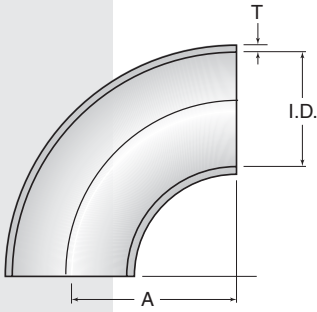

Material :
stainless steel
304L, 316L.

- Other alloys available on request.

Wall thickness tolerance according to ASTM A 774

- Other diameters and thicknesses available on request.
- Refer to technical section for maximum working pressure.

I.D. 90° Elbows								
Nom. dia.	I.D.		A		T		Approx. weight	
	inches	mm	inches	mm	inches	mm	lbs	kgs
3"	3.00	76.20	4.50	114.30	0.078	2.00	1.98	0.90
					0.125	3.18	2.47	1.12
					0.188	4.78	3.06	1.39
4"	4.00	101.60	6.00	152.40	0.078	2.00	2.73	1.24
					0.125	3.18	4.37	1.98
					0.188	4.78	5.45	2.47
6"	6.00	152.40	9.00	228.60	0.078	2.00	7.56	3.43
					0.125	3.18	9.96	4.52
					0.188	4.78	12.36	5.61
8"	8.00	203.20	12.00	304.80	0.078	2.00	11.22	5.09
					0.125	3.18	17.20	7.80
					0.140	3.60	18.92	8.58
10"	10.00	254.00	15.00	381.00	0.109	2.76	22.91	10.39
					0.125	3.18	25.88	11.74
					0.140	3.60	30.64	13.90
12"	12.00	304.80	18.00	457.20	0.109	2.76	33.33	15.12
					0.125	3.18	39.31	17.83
					0.140	3.60	41.34	18.75
14"	14.00	355.60	21.00	533.40	0.109	2.76	47.62	21.60
					0.125	3.18	52.78	23.94
					0.140	3.60	54.78	24.85
16"	16.00	406.40	24.00	609.60	0.109	2.76	61.16	27.74
					0.125	3.18	66.69	30.25
					0.140	3.60	78.04	35.40
18"	18.00	457.20	27.00	685.80	0.109	2.76	77.67	35.23
					0.125	3.18	83.19	37.71
					0.140	3.60	85.19	38.62
20"	20.00	508.00	30.00	762.00	0.109	2.76	93.59	42.45
					0.125	3.18	100.52	45.61
					0.140	3.60	102.52	46.52
24"	24.00	609.60	36.00	914.40	0.125	3.18	124.45	56.45
					0.140	3.60	126.45	57.36
					0.188	4.78	152.40	69.10
30"	30.00	762.00	45.00	1143.00	0.125	3.18	169.80	77.02
					0.140	3.60	171.80	77.93
					0.188	4.78	203.70	92.40
36"	36.00	914.40	54.00	1371.60	0.125	3.18	231.92	105.20
					0.140	3.60	233.92	106.11
					0.188	4.78	275.80	125.10
42"	42.00	1066.80	63.00	1600.20	0.125	3.18	308.64	140.00
					0.140	3.60	310.64	140.91
					0.188	4.78	362.50	164.40
48"	48.00	1219.20	72.00	1828.80	0.125	3.18	395.52	179.80
					0.140	3.60	397.52	180.71
					0.188	4.78	469.40	212.90
60"	60.00	1524.00	90.00	2286.00	0.125	3.18	504.00	228.60
					0.140	3.60	506.00	229.51
					0.188	4.78	597.90	270.90
72"	72.00	1828.80	108.00	2743.20	0.125	3.18	633.60	287.40
					0.140	3.60	635.60	288.31
					0.188	4.78	759.50	344.70
84"	84.00	2133.60	126.00	3200.40	0.125	3.18	784.32	356.10
					0.140	3.60	786.32	357.01
					0.188	4.78	940.20	425.40
96"	96.00	2438.40	144.00	3657.60	0.125	3.18	945.60	428.40
					0.140	3.60	947.60	429.31
					0.188	4.78	1131.50	512.70
108"	108.00	2743.20	162.00	4114.80	0.125	3.18	1128.00	509.40
					0.140	3.60	1130.00	510.31
					0.188	4.78	1335.90	604.70
120"	120.00	3048.00	180.00	4572.00	0.125	3.18	1332.00	603.60
					0.140	3.60	1334.00	604.51
					0.188	4.78	1569.90	708.90
144"	144.00	3657.60	216.00	5443.20	0.125	3.18	1603.20	727.20
					0.140	3.60	1605.20	728.11
					0.188	4.78	1929.10	876.90
168"	168.00	4267.20	252.00	6414.00	0.125	3.18	1900.80	864.00
					0.140	3.60	1902.80	864.91
					0.188	4.78	2287.70	1036.70
192"	192.00	4876.80	288.00	7384.80	0.125	3.18	2222.40	1008.00
					0.140	3.60	2224.40	1008.91
					0.188	4.78	2711.30	1230.90
216"	216.00	5486.40	324.00	8355.60	0.125	3.18	2577.60	1170.00
					0.140	3.60	2579.60	1170.91
					0.188	4.78	3086.50	1398.90
240"	240.00	6096.00	360.00	9326.40	0.125	3.18	3067.20	1392.00
					0.140	3.60	3069.20	1392.91
					0.188	4.78	3688.10	1668.90
264"	264.00	6705.60	396.00	10297.20	0.125	3.18	3595.20	1620.00
					0.140	3.60	3597.20	1620.91
					0.188	4.78	4234.10	1908.90
288"	288.00	7315.20	432.00	11268.00	0.125	3.18	4161.60	1872.00
					0.140	3.60	4163.60	1872.91
					0.188	4.78	4925.50	2238.90
312"	312.00	7924.80	468.00	12238.80	0.125	3.18	4771.20	2160.00
					0.140	3.60	4773.20	2160.91
					0.188	4.78	5644.10	2556.90
336"	336.00	8534.40	504.00	13209.60	0.125	3.18	5421.60	2448.00
					0.140	3.60	5423.60	2448.91
					0.188	4.78	6394.50	2908.90
360"	360.00	9144.00	540.00	14180.40	0.125	3.18	6115.20	2754.00
					0.140	3.60	6117.20	2754.91
					0.188	4.78	7205.10	3258.90
384"	384.00	9753.60	576.00	15151.20	0.125	3.18	6854.40	3096.00
					0.140	3.60	6856.40	3096.91
					0.188	4.78	8059.30	3654.90
408"	408.00	10363.20	612.00	16122.00	0.125	3.18	7641.60	3456.00
					0.140	3.60	7643.60	3456.91
					0.188	4.78	8956.50	4056.90
432"	432.00	10972.80	648.00	17092.80	0.125	3.18	8476.80	3834.00
					0.140	3.60	8478.80	3834.91
					0.188	4.78	9993.70	4538.90
456"	456.00	11582.40	684.00	18063.60	0.125	3.18	9364.80	4236.00
					0.140	3.60	9366.80	4236.91
					0.188	4.78	10991.70	4956.90
480"	480.00	12192.00	720.00	19034.40	0.125	3.18	10305.60	4656.00
					0.140	3.60	10307.60	4656.91
					0.188	4.78	12046.50	5466.90
504"	504.00	12801.60	756.00	19999.20	0.125	3.18	11304.00	5094.00
					0.140	3.60	11306.00	5094.91
					0.188	4.78	13350.90	6018.90
528"	528.00	13411.20	792.00	20964.00	0.125	3.18	12360.00	5616.00
					0.140	3.60	12362.00	5616.91
					0.188	4.78	14516.90	6588.90
552"	552.00	14020.80	828.00	21928.80	0.125	3.18	13473.60	6138.00
					0.140	3.60	13475.60	6138.91
					0.188	4.78	15780.50	7168.90
576"	576.00	14630.40	864.00	22893.60	0.125	3.18	14644.80	6660.00
					0.140	3.60	14646.80	6660.91
					0.188	4.78	17191.70	7768.90
600"	600.00	15240.00	900.00	23858.40	0.125	3.18	15873.60	7200.00
					0.140	3.60	15875.60	7200.91
					0.188	4.78	18422.50	8364.90
624"	624.00	15849.60	936.00	24823.20	0.125	3.18	17164.80	7752.00
					0.140	3.60	17166.80	7752.91
					0.188	4.78	20079.70	9096.90
648"	648.00	16459.20	972.00	25788.00	0.125	3.18	18518.40	8316.00
					0.140	3.60	18520.40	8316.91
					0.188	4.78	21643.30	9768.90
672"	672.00	17068.80	1008.00	26752.80	0.125	3.18	19934.40	8904.00
					0.140	3.60	19936.40	8904.91
					0.188	4.78	23129.30	10488.90
696"	696.00	17678.40	1044.00	27717.60	0.125	3.18	21412.80	9516.00
					0.140	3.60	21414.80	9516.91
					0.188	4.78	24784.70	11148.90
720"	720.00	18288.00	1080.00	28682.40	0.125	3.18	22953.60	10152.00
					0.140	3.60	22955.60	10152.91
					0.188	4.78	26330.50	11892.90
744"	744.00	18897.60	1116.00	29647.20	0.125	3.18	24556.80	10812.00
					0.140	3.60	24558.80	10812.91
					0.188	4.78	28001.70	12648.90
768"	768.00	19507.20	1152.00	30612.00	0.125	3.18	26222.40	11496.00
					0.140	3.60	26224.40	11496.91
					0.188	4.78	30506.30	13788.90
792"	792.00	20116.80	1188.00	31576.80	0.125	3.18	27950.40	12204.00
					0.140	3.60	27952.40	12204.91
					0.188	4.78	32001.30	14544.90
816"	816.00	20726.40	1224.00	32541.60	0.125	3.18	29740.80	12936.00
					0.140	3.60	29742.80	12936.91
					0.188	4.78	33526.70	15192.90
840"	840.00	21336.00	1260.00	33506.40	0.125	3.18	31593.60	13692.00
					0.140	3.60		

ASTM A 774

I.D. 45° Elbows

Nom. dia.	I.D.		B		T		Approx. weight	
	inches	mm	inches	mm	inches	mm	lbs	kgs
3"	3.00	76.20	1.875	47.63	0.078	2.00	0.99	0.45
					0.125	3.18	1.23	0.56
4"	4.00	101.60	2.500	63.50	0.078	2.00	1.37	0.62
					0.125	3.18	2.18	0.99
6"	6.00	152.40	3.750	95.25	0.078	2.00	3.79	1.72
					0.125	3.18	4.98	2.26
8"	8.00	203.20	5.000	127.00	0.078	2.00	5.62	2.55
					0.125	3.18	8.60	3.90
					0.140	3.60	9.46	4.29
10"	10.00	254.00	6.250	158.75	0.109	2.76	11.46	5.20
					0.125	3.18	12.94	5.87
					0.140	3.60	15.32	6.95
12"	12.00	304.80	7.500	190.50	0.109	2.76	16.67	7.56
					0.125	3.18	19.64	8.91
					0.140	3.60	20.68	9.38
14"	14.00	355.60	8.750	222.25	0.109	2.76	23.81	10.80
					0.125	3.18	26.39	11.97
					0.140	3.60	27.40	12.43
					0.156	4.00	34.04	15.44
					0.188	4.78	38.85	17.62
16"	16.00	406.40	10.000	254.00	0.109	2.76	30.58	13.87
					0.125	3.18	33.36	15.13
					0.140	3.60	39.02	17.70
					0.188	4.78	52.78	23.94
					0.250	6.35	68.78	31.20
18"	18.00	457.20	11.250	285.75	0.125	3.18	46.80	21.23
					0.140	3.60	55.12	25.00
					0.188	4.78	62.24	28.23
					0.250	6.35	84.90	38.51
20"	20.00	508.00	12.500	317.50	0.125	3.18	54.12	24.55
					0.140	3.60	60.85	27.60
					0.188	4.78	80.47	36.50
					0.250	6.35	107.83	48.91
24"	24.00	609.60	15.000	381.00	0.140	3.60	87.63	39.75
					0.188	4.78	115.96	52.60
					0.250	6.65	154.32	70.00
					0.375	9.53	228.00	103.42
30"	30.00	711.20	18.500	469.90	0.188	4.78	180.01	81.65
					0.250	6.35	239.51	108.64
					0.375	9.53	357.50	162.16

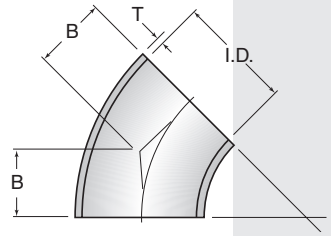

*Material:
stainless steel
304L, 316L.*

- Other alloys available on request.

*Wall thickness
tolerance according
to ASTM A 774*

- Other diameters and thicknesses available on request.
- Refer to technical section for maximum working pressure.

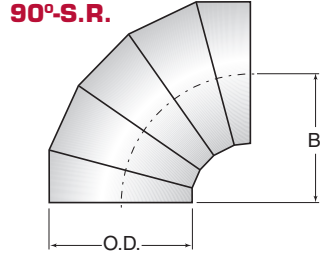
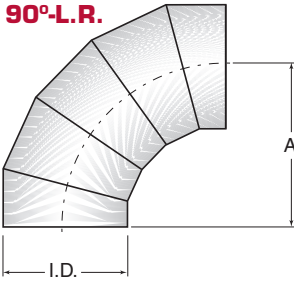

Material :
stainless steel
304L, 316L.

Other alloys available
on request.

Wall thickness
tolerance according
to ASTM A 774.

Available in same
thickness as pipe.

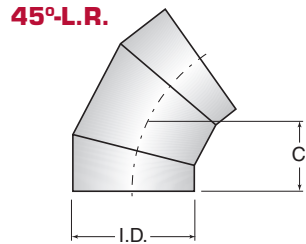

ASTM A 774

I.D. Mitered Elbows							
Inside diameter		A		B		C	
inches	mm	inches	mm	inches	mm	inches	mm
3	76	7 3/4	197	5 1/2	140	3	76
4	102	9	229	6 1/2	165	4	102
5	127	10 1/4	260	7 1/2	178	4 1/2	114
6	152	11 1/2	292	8	203	5	127
8	203	14	356	9	229	5 1/2	140
10	254	16 1/2	419	11	279	6 1/2	165
12	305	19	483	12	305	7 1/2	191
14	356	21 1/2	546	14	356	7 1/2	191
16	406	24	610	15	381	8	203
18	457	26 1/2	673	16 1/2	419	8 1/2	216
20	508	29	737	18	457	9 1/2	241
24	610	34	864	22	559	11	279
30	762	41 1/2	1054	25	635	15	381
36	914	49	1245	28	711	18	457

- Other diameters available on request.
- Refer to technical section for maximum working pressure.

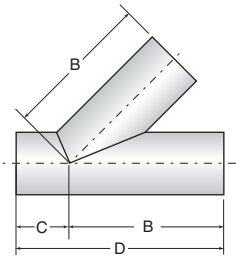
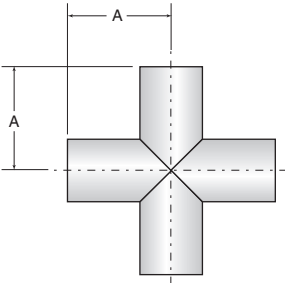
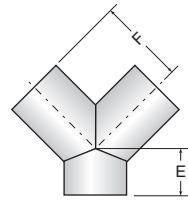
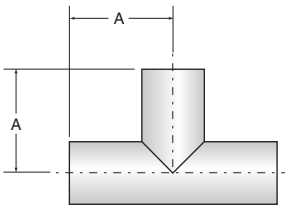

*Material:
stainless steel
304L, 316L.*

*Other alloys available
on request.*

*Wall thickness
tolerance according
to ASTM A 774.*

*Available in same
thickness as pipe.*

ASTM A 774

I.D. Tees, Crosses, Laterals and Wyes.

Inside diameter		Tees & crosses		Laterals						Wyes			
		A		B		C		D		E		F	
inches	mm	inches	mm	inches	mm	inches	mm	inches	mm	inches	mm	inches	mm
3	76	5 1/2	140	10	254	3	76	13	330	3	76	5 1/2	140
4	102	6 1/2	165	12	305	3	76	15	381	3	76	6 1/2	165
5	127	7 1/2	191	13 1/2	343	3 1/2	89	17	432	3 1/2	89	7 1/2	191
6	152	8	203	14 1/2	368	3 1/2	89	18	457	3 1/2	89	8	203
8	203	9	229	17 1/2	444	4 1/2	114	22	559	4 1/2	114	9	227
10	254	11	279	20 1/2	521	5	127	25 1/2	648	5	127	11	279
12	305	12	305	24 1/2	622	5 1/2	140	30	762	5 1/2	140	12	305
14	356	14	356	27	686	6	152	33	838	6	152	14	356
16	406	15	381	30	762	6 1/2	165	36 1/2	927	6 1/2	165	15	381
18	457	16 1/2	419	32	813	7	178	39	991	7	178	16 1/2	419
20	508	18	457	35	889	8	203	43	1092	8	203	18	457
24	610	22	559	40 1/2	1029	9	229	49 1/2	1257	9	229	22	559
30	762	25	635	49	1245	10	254	59	1499	10	254	25	635
36	914	28	711	58	1474	14	356	72	1830	11	279	28	711

- Reducing Tees, Crosses, Laterals and Wyes are available on request.
- Other diameters available on request.
- Refer to technical section for maximum working pressure.

ASTM A 774

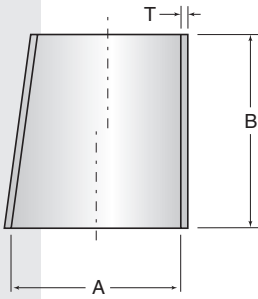

Eccentric

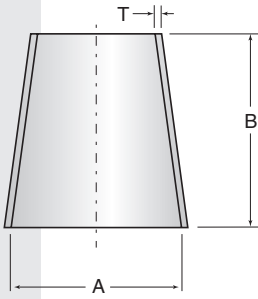

Concentric

Material :
stainless steel
304L, 316L.

Other alloys
available on
request.

Wall thickness
tolerance according
to ASTM A 774

- Multiple step available on request.
- Other diameters and thicknesses available on request.
- Refer to technical section for maximum working pressure.

I.D. Reducers

Nom. dia.	A		B		T	
	inches	mm	inches	mm	inches	mm
3"	3.00	76.20	6.00	152.40	0.078	2.00
					0.109	2.76
					0.125	3.18
4"	4.00	101.60	7.00	177.80	0.078	2.00
					0.109	2.76
					0.125	3.18
6"	6.00	152.50	9.00	139.70	0.083	2.00
					0.109	2.76
					0.121	3.18
8"	8.00	203.20	11.00	279.40	0.078	2.00
					0.109	2.76
					0.125	3.18
10"	10.00	254.00	12.00	304.80	0.078	2.00
					0.109	2.76
					0.125	3.18
12"	12.00	304.80	14.00	355.60	0.078	2.00
					0.109	2.76
					0.125	3.18
14"	14.00	355.60	16.00	406.40	0.109	2.76
					0.125	3.18
					0.140	3.40
16"	16.00	406.40	18.00	457.20	0.109	2.76
					0.125	3.18
					0.140	3.40
18"	18.00	457.20	19.00	482.60	0.109	2.76
					0.125	3.18
					0.140	3.40
20"	20.00	508.00	20.00	508.00	0.125	3.18
					0.140	3.40
					0.188	4.76
24"	24.00	609.60	24.00	609.60	0.250	6.35
					0.125	3.18
					0.140	3.40
30"	30.00	762.00	30.00	762.00	0.188	4.76
					0.250	6.35
					0.140	3.40
36"	36.00	914.40	36.00	914.40	0.140	3.40
					0.188	4.76
					0.250	6.35

I.D. Pressed Collars

ASTM A 774

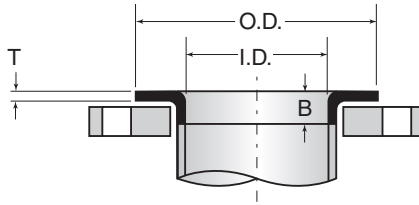

Butt weld

Nominal pipe dia.		I.D.		O.D.		T	B		Approx. weight	
inches	mm	inches	mm	inches	mm	gauge	inches	mm	lbs	kgs
3	76.2	3	76.2	5	127.0	11	11/16	17.4	0.5	0.2
4	101.6	4	101.6	6 1/2	165.1	11	11/16	17.4	0.8	0.4
6	152.4	6	152.4	8 1/2	215.9	11	11/16	17.4	1.2	0.5

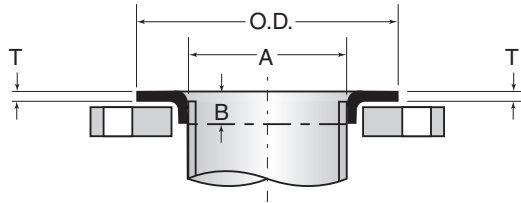

Available on request

Slip-on

Nominal pipe dia.		A		O.D.		T	B		Approx. weight	
inches	mm	inches	mm	inches	mm	gauge	inches	mm	lbs	kgs
3	76.2	3 5/16	76.2	5	127.0	11	11/16	17.4	0.5	0.2
4	101.6	4 5/16	101.6	6 1/2	165.1	11	11/16	17.4	0.8	0.4
6	152.4	6 5/16	152.4	8 1/2	215.9	11	11/16	17.4	1.2	0.5

Material : *Wall thickness*
 stainless steel *tolerance according*
 304L, 316L. *to ASTM A 774.*

- Refer to technical section for maximum working pressure.

I.D. Rolled Angle Vanstones

ASTM A 774

Material :
stainless steel 316L.

Other alloys available
on request.

Wall thickness
tolerance according
to ASTM A 774.

Available in same
thickness as pipe.

Slip-on collars supplied
to suit pipe's outside
diameter.

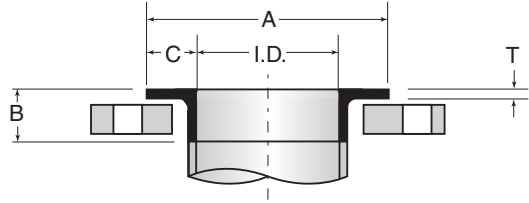

Butt weld

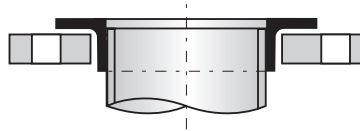

Slip-on

I.D. Angle Vanstones (collars)

Inside diameter		A		B-C-T		Approx. weight	
inches	mm	inches	mm	inches	mm	lbs	kgs
3	76.2	4 1/2	114.3	3/4 x 3/4 x 1/8	19.0 x 19.0 x 3.2	0.5	0.2
4	101.6	6	152.4	1 x 1 x 1/8	25.4 x 25.4 x 3.2	0.7	0.3
5	127.0	7	177.8	1 x 1 x 1/8	25.4 x 25.4 x 3.2	1.0	0.4
6	152.4	8	203.2	1 x 1 x 1/8	25.4 x 25.4 x 3.2	1.4	0.6
8	203.2	10 1/2	266.7	1 1/4 x 1 1/4 x 1/8	31.7 x 31.7 x 3.2	2.4	0.9
10	254.0	13	330.2	1 1/2 x 1 1/2 x 1/8	38.1 x 38.1 x 3.2	3.5	1.6
12	304.8	15	381.0	1 1/2 x 1 1/2 x 1/8	38.1 x 38.1 x 3.2	4.1	1.9
14	355.6	17	431.8	1 1/2 x 1 1/2 x 1/8	38.1 x 38.1 x 3.2	4.8	2.2
16	406.4	19	482.6	1 1/2 x 1 1/2 x 3/16	38.1 x 38.1 x 4.8	8.2	3.7
18	457.2	21	533.4	1 1/2 x 1 1/2 x 3/16	38.1 x 38.1 x 4.8	9.0	4.1
20	508.0	23	584.2	1 1/2 x 1 1/2 x 3/16	38.1 x 38.1 x 4.8	10.0	4.5
24	609.6	28	711.2	2 x 2 x 1/4	50.8 x 50.8 x 6.3	21.0	9.5
30	762.0	34	863.6	2 x 2 x 1/4	50.8 x 50.8 x 6.3	25.5	11.6
36	914.4	40	1016.0	2 x 2 x 1/4	50.8 x 50.8 x 6.3	30.5	13.8

- Other diameters and thicknesses available on request.
- Refer to technical section for maximum working pressure.

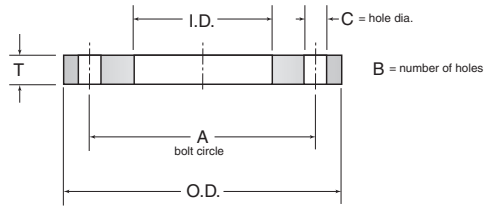
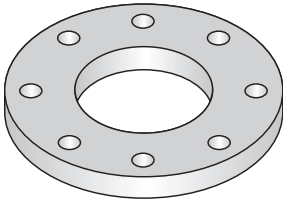

I.D. Backing Flanges (rings)

Nom. pipe dia.		O.D.		I.D.		T1 (thickness)		T2 (thickness)		T3 (thickness)	
inches	mm	inches	mm	inches	mm	inches	mm	inches	mm	inches	mm
3	76	7 1/2	191	3 5/8	92	5/8	15.9	3/4	19.0	3/4	19.0
4	102	9	229	4 5/8	117	5/8	15.9	3/4	19.0	3/4	19.0
5	127	10	254	5 5/8	143	5/8	15.9	3/4	19.0	3/4	19.0
6	152	11	279	6 5/8	168	5/8	15.9	3/4	19.0	3/4	19.0
8	203	13 1/2	343	8 5/8	219	5/8	15.9	3/4	19.0	7/8	22.2
10	254	16	407	10 3/4	273	3/4	19.0	1	25.4	1	25.4
12	305	19	483	12 3/4	324	3/4	19.0	1	25.4	1 1/4	31.7
14	356	21	534	14 3/4	375	3/4	19.0	1 1/8	28.6	1 1/4	31.7
16	406	23 1/2	597	16 3/4	425	3/4	19.0	1 1/8	28.6	1 1/2	38.1
18	457	25	635	18 3/4	476	1	25.4	1 1/4	31.7	1 1/2	38.1
20	508	27 1/2	699	20 7/8	530	1	25.4	1 1/4	31.7	1 5/8	41.2
24	610	32	813	24 7/8	632	1	25.4	1 3/8	34.9	2	51.0
30	762	39	985	31	787	1	25.4	1 1/2	38.1	2 3/8	60.3
36	914	46	1169	37	940	1	25.4	1 1/2	38.1	2 7/8	73.0

Nom. pipe dia.		A		B	C		T1 (weight)		T2 (weight)		T3 (weight)	
inches	mm	inches	mm	# of holes	inches	mm	lbs	kgs	lbs	kgs	lbs	kgs
3	76	6	152	4	3/4	19.0	5.9	2.7	7.1	3.2	7.1	3.2
4	102	7 1/2	190	8	3/4	19.0	7.9	3.6	9.5	4.3	9.5	4.3
5	127	8 1/2	216	8	7/8	22.2	8.9	4.0	10.7	4.9	10.7	4.9
6	152	9 1/2	241	8	7/8	22.2	10.3	4.7	12.3	5.6	12.3	5.6
8	203	11 3/4	298	8	7/8	22.2	14.7	6.7	17.7	8.0	20.6	9.4
10	254	14 1/4	362	12	1	25.4	18.9	8.6	30.2	13.7	30.2	13.7
12	305	17	432	12	1	25.4	32.7	14.8	43.5	19.7	54.4	24.7
14	356	18 3/4	476	12	1 1/8	28.6	36.6	16.6	55.0	25.0	78.6	35.7
16	406	21 1/4	540	16	1 1/8	28.6	44.0	20.0	66.0	29.9	88.3	40.1
18	457	22 3/4	578	16	1 1/4	31.7	48.8	22.1	81.4	36.9	97.6	44.4
20	508	25	635	20	1 1/4	31.7	69.0	31.3	86.3	39.1	112.0	50.9
24	610	29 1/2	749	20	1 3/8	34.9	88.0	39.9	121.0	44.9	176.0	80.2
30	762	36	914	28	1 3/8	34.9	117.0	53.1	176.0	79.8	279.0	126.7
36	914	42 3/4	1086	32	1 5/8	41.3	158.0	71.7	237.0	107.5	454.0	206.5

(approximate weight)

- **Material :** T1, T2=mild steel. T3=A516Gr.70.
- **Drilling :** ASME B16,5 CL.150
- **Note :** T3 upon request only.
- **Finish :** galvanized
- **Maximum working pressure :**
Refer to technical section.

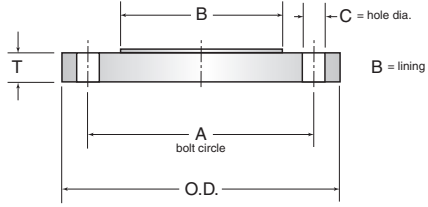
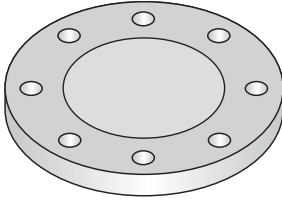

I.D. Blind Flanges

Nom. pipe dia.		O.D.		A		B	
inches	mm	inches	mm	inches	mm	inches	mm
3	76	7 1/2	191	6	152	4 1/2	114.3
4	102	9	229	7 1/2	190	6	152.4
5	127	10	254	8 1/2	215	7	177.8
6	152	11	279	9 1/2	241	8	203.2
8	203	13 1/2	343	11 3/4	298	10 1/2	266.7
10	254	16	407	14 1/4	362	13	330.2
12	305	19	483	17	432	15	381.0
14	356	21	534	18 3/4	476	17	431.8
16	406	23 1/2	597	21 1/4	540	19	482.6
18	457	25	635	22 3/4	578	21	533.4
20	508	27 1/2	699	25	635	23	584.2
24	610	32	813	29 1/2	749	28	711.2
30	762	38 3/4	985	36	914	34	863.6
36	914	46	1169	42 3/4	1086	40	1016.0

Nom. pipe dia.		T		number of holes	C		Approx. weight	
inches	mm	inches	mm		inches	mm	lbs	kgs
3	76	3/4	19.0	4	3/4	19.0	9.8	4.5
4	102	3/4	19.0	8	3/4	19.0	14.0	6.4
5	127	3/4	19.0	8	7/8	22.2	17.6	8.0
6	152	3/4	19.0	8	7/8	22.2	21.3	9.7
8	203	3/4	19.0	8	7/8	22.2	32.2	14.6
10	254	1	25.4	12	1	25.4	58.0	26.5
12	305	1	25.4	12	1	25.4	83.1	37.8
14	356	1 1/8	28.6	12	1 1/8	28.6	113.0	51.4
16	406	1 1/8	28.6	16	1 1/8	28.6	142.0	64.5
18	457	1 1/4	31.7	16	1 1/4	31.7	179.0	81.4
20	508	1 1/4	31.7	20	1 1/4	31.7	217.5	98.9
24	610	1 3/8	34.9	20	1 3/8	34.9	323.0	146.8
30	762	1 1/2	38.1	28	1 3/8	34.9	530.0	240.4
36	914	1 1/2	38.1	32	1 5/8	41.3	755.0	342.5

- **Material** : Mild steel with 316L lining.
- **Drilling** : ASME B16.5 CL.150
- **Finish** : galvanized
- **Maximum working pressure** : Refer to technical section.