

# Tuyau D.I.

## ASTM A 778

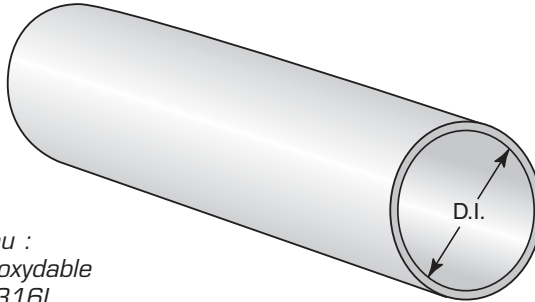

Matériau :  
acier inoxydable  
304L, 316L.

Autres alliages disponibles  
sur demande.

Tolérance selon  
ASTM A 778.

Disponible en longueurs  
de 20 pieds.

### Poids approximatif (livres/pied - kilos/mètre)

| Dia. intérieur |       | Jauge 14 |       | 12     |       | 11     |       | 10     |       | 3/16"  |       | 1/4"   |       |
|----------------|-------|----------|-------|--------|-------|--------|-------|--------|-------|--------|-------|--------|-------|
| pouce          | mm    | lbs/pi   | kgs/m | lbs/pi | kgs/m | lbs/pi | kgs/m | lbs/pi | kgs/m | lbs/pi | kgs/m | lbs/pi | kgs/m |
| 3              | 76.2  | 2.6      | 3.9   | 3.7    | 5.5   | 4.2    | 6.3   |        |       |        |       |        |       |
| 4              | 101.6 | 3.5      | 5.2   | 4.9    | 26.9  | 5.6    | 8.4   |        |       |        |       |        |       |
| 5              | 127.0 | 4.4      | 6.6   | 6.1    | 9.1   | 7.0    | 10.5  |        |       |        |       |        |       |
| 6              | 152.4 | 5.2      | 7.8   | 7.3    | 10.9  | 8.4    | 12.6  |        |       |        |       |        |       |
| 8              | 203.2 | 7.1      | 10.6  | 9.9    | 14.8  | 11.2   | 16.8  |        |       |        |       |        |       |
| 10             | 254.0 | 8.6      | 12.9  | 12.2   | 18.3  | 14.0   | 21.0  |        |       |        |       |        |       |
| 12             | 304.8 | 10.4     | 15.6  | 14.7   | 22.0  | 16.8   | 25.2  |        |       |        |       |        |       |
| 14             | 355.6 |          |       | 17.2   | 25.8  | 19.6   | 29.4  | 21.8   | 32.7  | 31.2   | 46.8  |        |       |
| 16             | 406.4 |          |       |        |       | 22.2   | 33.3  | 25.0   | 37.5  | 35.6   | 53.4  |        |       |
| 18             | 457.2 |          |       |        |       | 24.8   | 37.2  | 28.1   | 42.1  | 36.5   | 56.6  | 52.1   | 78.1  |
| 20             | 508.0 |          |       |        |       | 27.8   | 41.7  | 31.3   | 46.9  | 40.6   | 63.0  | 57.9   | 86.8  |
| 24             | 609.6 |          |       |        |       | 33.2   | 49.8  | 37.5   | 56.2  | 49.0   | 73.5  | 69.6   | 104.4 |
| 30             | 762.0 |          |       |        |       | 41.7   | 62.5  |        |       | 68.7   | 103.0 | 84.0   | 126.0 |
| 36             | 914.4 |          |       |        |       | 49.4   | 74.1  |        |       | 82.0   | 123.0 | 106.0  | 159.0 |

- Autres diamètres et épaisseurs disponibles sur demande.
- Voir section technique pour pression maximale.

## ASTM A 774

### Coudes D.I. 90°

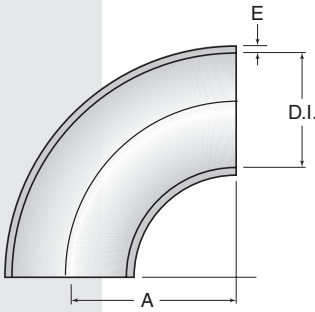

*Matériau :*  
acier inoxydable  
304L, 316L.

- Autres alliages disponibles sur demande.

*Tolérance selon  
ASTM A 774*

- Autres diamètres et épaisseurs disponibles sur demande.
- Voir section technique pour pression maximale.

| Dia. nom. | D.I.   |        | A      |         | E      |      | Poids Approx. |        |
|-----------|--------|--------|--------|---------|--------|------|---------------|--------|
|           | pouces | mm     | pouces | mm      | pouces | mm   | lbs           | kgs    |
| 3"        | 3.00   | 76.20  | 4.50   | 114.30  | 0.078  | 2.00 | 1.98          | 0.90   |
|           |        |        |        |         | 0.125  | 3.18 | 2.47          | 1.12   |
| 4"        | 4.00   | 101.60 | 6.00   | 152.40  | 0.078  | 2.00 | 2.73          | 1.24   |
|           |        |        |        |         | 0.125  | 3.18 | 4.37          | 1.98   |
| 6"        | 6.00   | 152.40 | 9.00   | 228.60  | 0.078  | 2.00 | 7.56          | 3.43   |
|           |        |        |        |         | 0.125  | 3.18 | 9.96          | 4.52   |
| 8"        | 8.00   | 203.20 | 12.00  | 304.80  | 0.078  | 2.00 | 11.22         | 5.09   |
|           |        |        |        |         | 0.125  | 3.18 | 17.20         | 7.80   |
|           |        |        |        |         | 0.140  | 3.60 | 18.92         | 8.58   |
| 10"       | 10.00  | 254.00 | 15.00  | 381.00  | 0.109  | 2.76 | 22.91         | 10.39  |
|           |        |        |        |         | 0.125  | 3.18 | 25.88         | 11.74  |
|           |        |        |        |         | 0.140  | 3.60 | 30.64         | 13.90  |
| 12"       | 12.00  | 304.80 | 18.00  | 457.20  | 0.109  | 2.76 | 33.33         | 15.12  |
|           |        |        |        |         | 0.125  | 3.18 | 39.31         | 17.83  |
|           |        |        |        |         | 0.140  | 3.60 | 41.34         | 18.75  |
| 14"       | 14.00  | 355.60 | 21.00  | 533.40  | 0.109  | 2.76 | 47.62         | 21.60  |
|           |        |        |        |         | 0.125  | 3.18 | 52.78         | 23.94  |
|           |        |        |        |         | 0.140  | 3.60 | 54.78         | 24.85  |
|           |        |        |        |         | 0.156  | 4.00 | 68.10         | 30.89  |
| 16"       | 16.00  | 406.40 | 24.00  | 609.60  | 0.188  | 4.78 | 77.67         | 35.23  |
|           |        |        |        |         | 0.109  | 2.76 | 61.16         | 27.74  |
|           |        |        |        |         | 0.125  | 3.18 | 66.69         | 30.25  |
|           |        |        |        |         | 0.140  | 3.60 | 78.04         | 35.40  |
| 18"       | 18.00  | 457.20 | 27.00  | 685.80  | 0.188  | 4.78 | 105.53        | 47.87  |
|           |        |        |        |         | 0.250  | 6.35 | 137.57        | 62.40  |
|           |        |        |        |         | 0.125  | 3.18 | 93.59         | 42.45  |
|           |        |        |        |         | 0.140  | 3.60 | 110.52        | 50.13  |
| 20"       | 20.00  | 508.00 | 30.00  | 762.00  | 0.188  | 4.78 | 124.45        | 56.45  |
|           |        |        |        |         | 0.250  | 6.35 | 169.80        | 77.02  |
|           |        |        |        |         | 0.125  | 3.18 | 108.25        | 49.10  |
|           |        |        |        |         | 0.140  | 3.60 | 121.69        | 55.20  |
| 24"       | 24.00  | 609.60 | 36.00  | 914.90  | 0.188  | 4.78 | 160.94        | 73.00  |
|           |        |        |        |         | 0.250  | 6.35 | 215.65        | 98.72  |
|           |        |        |        |         | 0.140  | 3.60 | 175.27        | 79.50  |
|           |        |        |        |         | 0.188  | 4.78 | 231.92        | 105.20 |
| 30"       | 30.00  | 711.20 | 45.00  | 1143.00 | 0.250  | 6.65 | 308.64        | 140.00 |
|           |        |        |        |         | 0.375  | 9.53 | 456.00        | 206.84 |
|           |        |        |        |         | 0.188  | 4.78 | 359.99        | 163.29 |
|           |        |        |        |         | 0.250  | 6.35 | 478.99        | 217.27 |
|           |        |        |        |         | 0.375  | 9.53 | 715.00        | 324.32 |

## ASTM A 774

### Coudes D.I. 45°

| Dia.<br>nom. | D.I.   |        | B      |        | E      |      | Poids Approx. |        |
|--------------|--------|--------|--------|--------|--------|------|---------------|--------|
|              | pouces | mm     | pouces | mm     | pouces | mm   | lbs           | kgs    |
| 3"           | 3.00   | 76.20  | 1.875  | 47.63  | 0.078  | 2.00 | 0.99          | 0.45   |
|              |        |        |        |        | 0.125  | 3.18 | 1.23          | 0.56   |
| 4"           | 4.00   | 101.60 | 2.500  | 63.50  | 0.078  | 2.00 | 1.37          | 0.62   |
|              |        |        |        |        | 0.125  | 3.18 | 2.18          | 0.99   |
| 6"           | 6.00   | 152.40 | 3.750  | 95.25  | 0.078  | 2.00 | 3.79          | 1.72   |
|              |        |        |        |        | 0.125  | 3.18 | 4.98          | 2.26   |
| 8"           | 8.00   | 203.20 | 5.000  | 127.00 | 0.078  | 2.00 | 5.62          | 2.55   |
|              |        |        |        |        | 0.125  | 3.18 | 8.60          | 3.90   |
|              |        |        |        |        | 0.140  | 3.60 | 9.46          | 4.29   |
| 10"          | 10.00  | 254.00 | 6.250  | 158.75 | 0.109  | 2.76 | 11.46         | 5.20   |
|              |        |        |        |        | 0.125  | 3.18 | 12.94         | 5.87   |
|              |        |        |        |        | 0.140  | 3.60 | 15.32         | 6.95   |
| 12"          | 12.00  | 304.80 | 7.500  | 190.50 | 0.109  | 2.76 | 16.67         | 7.56   |
|              |        |        |        |        | 0.125  | 3.18 | 19.64         | 8.91   |
|              |        |        |        |        | 0.140  | 3.60 | 20.68         | 9.38   |
| 14"          | 14.00  | 355.60 | 8.750  | 222.25 | 0.109  | 2.76 | 23.81         | 10.80  |
|              |        |        |        |        | 0.125  | 3.18 | 26.39         | 11.97  |
|              |        |        |        |        | 0.140  | 3.60 | 27.40         | 12.43  |
|              |        |        |        |        | 0.156  | 4.00 | 34.04         | 15.44  |
|              |        |        |        |        | 0.188  | 4.78 | 38.85         | 17.62  |
| 16"          | 16.00  | 406.40 | 10.000 | 254.00 | 0.109  | 2.76 | 30.58         | 13.87  |
|              |        |        |        |        | 0.125  | 3.18 | 33.36         | 15.13  |
|              |        |        |        |        | 0.140  | 3.60 | 39.02         | 17.70  |
|              |        |        |        |        | 0.188  | 4.78 | 52.78         | 23.94  |
|              |        |        |        |        | 0.250  | 6.35 | 68.78         | 31.20  |
| 18"          | 18.00  | 457.20 | 11.250 | 285.75 | 0.125  | 3.18 | 46.80         | 21.23  |
|              |        |        |        |        | 0.140  | 3.60 | 55.12         | 25.00  |
|              |        |        |        |        | 0.188  | 4.78 | 62.24         | 28.23  |
|              |        |        |        |        | 0.250  | 6.35 | 84.90         | 38.51  |
| 20"          | 20.00  | 508.00 | 12.500 | 317.50 | 0.125  | 3.18 | 54.12         | 24.55  |
|              |        |        |        |        | 0.140  | 3.60 | 60.85         | 27.60  |
|              |        |        |        |        | 0.188  | 4.78 | 80.47         | 36.50  |
|              |        |        |        |        | 0.250  | 6.35 | 107.83        | 48.91  |
| 24"          | 24.00  | 609.60 | 15.000 | 381.00 | 0.140  | 3.60 | 87.63         | 39.75  |
|              |        |        |        |        | 0.188  | 4.78 | 115.96        | 52.60  |
|              |        |        |        |        | 0.250  | 6.65 | 154.32        | 70.00  |
|              |        |        |        |        | 0.375  | 9.53 | 228.00        | 103.42 |
| 30"          | 30.00  | 711.20 | 18.500 | 469.90 | 0.188  | 4.78 | 180.01        | 81.65  |
|              |        |        |        |        | 0.250  | 6.35 | 239.51        | 108.64 |
|              |        |        |        |        | 0.375  | 9.53 | 357.50        | 162.16 |

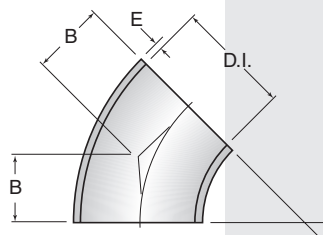

*Matériau :  
acier inoxydable  
304L, 316L.*

- Autres alliages disponibles sur demande.

*Tolérance selon  
ASTM A 774*

- Autres diamètres et épaisseurs disponibles sur demande.
- Voir section technique pour pression maximale.

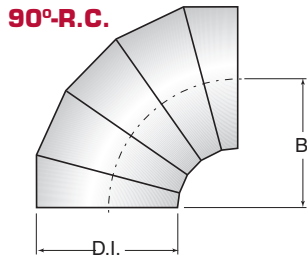
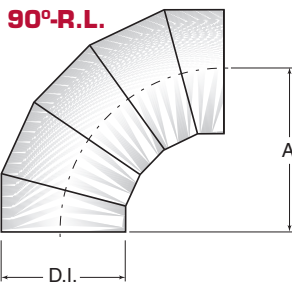

*Matériau :*  
acier inoxydable  
304L, 316L.

*Autres alliages disponibles  
sur demande.*

*Tolérance selon  
ASTM A 774.*

*Disponible dans les mêmes  
épaisseurs que le tuyau.*

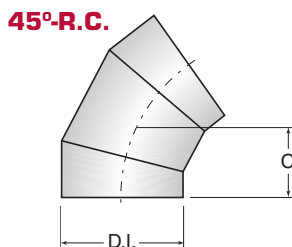

## ASTM A 774

### Coudes à onglets D.I. (mitred)

| Dia. intérieur |     | A      |      | B      |     | C      |     |
|----------------|-----|--------|------|--------|-----|--------|-----|
| pouces         | mm  | pouces | mm   | pouces | mm  | pouces | mm  |
| 3              | 76  | 7 3/4  | 197  | 5 1/2  | 140 | 3      | 76  |
| 4              | 102 | 9      | 229  | 6 1/2  | 165 | 4      | 102 |
| 5              | 127 | 10 1/4 | 260  | 7 1/2  | 178 | 4 1/2  | 114 |
| 6              | 152 | 11 1/2 | 292  | 8      | 203 | 5      | 127 |
| 8              | 203 | 14     | 356  | 9      | 229 | 5 1/2  | 140 |
| 10             | 254 | 16 1/2 | 419  | 11     | 279 | 6 1/2  | 165 |
| 12             | 305 | 19     | 483  | 12     | 305 | 7 1/2  | 191 |
| 14             | 356 | 21 1/2 | 546  | 14     | 356 | 7 1/2  | 191 |
| 16             | 406 | 24     | 610  | 15     | 381 | 8      | 203 |
| 18             | 457 | 26 1/2 | 673  | 16 1/2 | 419 | 8 1/2  | 216 |
| 20             | 508 | 29     | 737  | 18     | 457 | 9 1/2  | 241 |
| 24             | 610 | 34     | 864  | 22     | 559 | 11     | 279 |
| 30             | 762 | 41 1/2 | 1054 | 25     | 635 | 15     | 381 |
| 36             | 914 | 49     | 1245 | 28     | 711 | 18     | 457 |

- Autres diamètres disponibles sur demande.
- Voir section technique pour pression maximale.

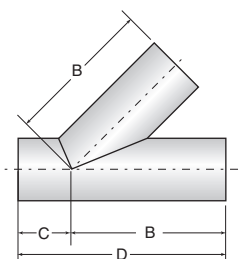
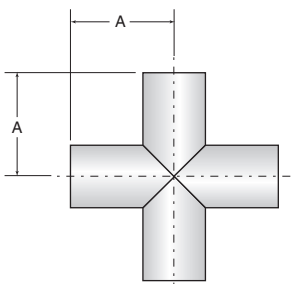
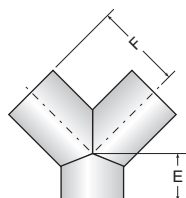
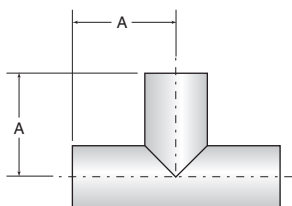

Matériau :  
acier inoxydable  
304L, 316L.

Autres alliages disponibles  
sur demande.

Tolérance selon  
ASTM A 774.

Disponible dans  
les mêmes épaisseurs  
que le tuyau.

## ASTM A 774

### Té, croix, latéral et Y, D.I.

| Dia.<br>intérieur |     | Té & croix |     | Latéral |      |        |     |        |      | Y      |     |        |     |
|-------------------|-----|------------|-----|---------|------|--------|-----|--------|------|--------|-----|--------|-----|
|                   |     | A          |     | B       |      | C      |     | D      |      | E      |     | F      |     |
| pouces            | mm  | pouces     | mm  | pouces  | mm   | pouces | mm  | pouces | mm   | pouces | mm  | pouces | mm  |
| 3                 | 76  | 5 1/2      | 140 | 10      | 254  | 3      | 76  | 13     | 330  | 3      | 76  | 5 1/2  | 140 |
| 4                 | 102 | 6 1/2      | 165 | 12      | 305  | 3      | 76  | 15     | 381  | 3      | 76  | 6 1/2  | 165 |
| 5                 | 127 | 7 1/2      | 191 | 13 1/2  | 343  | 3 1/2  | 89  | 17     | 432  | 3 1/2  | 89  | 7 1/2  | 191 |
| 6                 | 152 | 8          | 203 | 14 1/2  | 368  | 3 1/2  | 89  | 18     | 457  | 3 1/2  | 89  | 8      | 203 |
| 8                 | 203 | 9          | 229 | 17 1/2  | 444  | 4 1/2  | 114 | 22     | 559  | 4 1/2  | 114 | 9      | 227 |
| 10                | 254 | 11         | 279 | 20 1/2  | 521  | 5      | 127 | 25 1/2 | 648  | 5      | 127 | 11     | 279 |
| 12                | 305 | 12         | 305 | 24 1/2  | 622  | 5 1/2  | 140 | 30     | 762  | 5 1/2  | 140 | 12     | 305 |
| 14                | 356 | 14         | 356 | 27      | 686  | 6      | 152 | 33     | 838  | 6      | 152 | 14     | 356 |
| 16                | 406 | 15         | 381 | 30      | 762  | 6 1/2  | 165 | 36 1/2 | 927  | 6 1/2  | 165 | 15     | 381 |
| 18                | 457 | 16 1/2     | 419 | 32      | 813  | 7      | 178 | 39     | 991  | 7      | 178 | 16 1/2 | 419 |
| 20                | 508 | 18         | 457 | 35      | 889  | 8      | 203 | 43     | 1092 | 8      | 203 | 18     | 457 |
| 24                | 610 | 22         | 559 | 40 1/2  | 1029 | 9      | 229 | 49 1/2 | 1257 | 9      | 229 | 22     | 559 |
| 30                | 762 | 25         | 635 | 49      | 1245 | 10     | 254 | 59     | 1499 | 10     | 254 | 25     | 635 |
| 36                | 914 | 28         | 711 | 58      | 1474 | 14     | 356 | 72     | 1830 | 11     | 279 | 28     | 711 |

- Té, croix, latéral et Y réducteurs disponibles sur demande.
- Autres diamètres disponibles sur demande.
- Voir section technique pour pression maximale.

## ASTM A 774

### Réducteurs D.I.

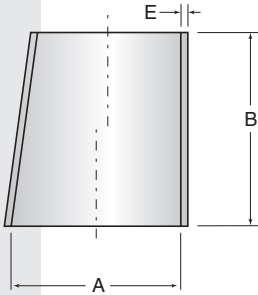

Excentrique

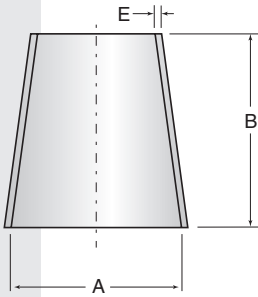

Concentrique

Matériau :  
acier inoxydable  
304L, 316L.

- Autres alliages disponibles sur demande.

Tolérance selon  
ASTM A 774

- Plus qu'une réduction disponible sur demande.
- Autres diamètres et épaisseurs disponibles sur demande.
- Voir section technique pour pression maximale.

| Tuyau<br>dia. nom. | A      |        | B      |        | E      |      |
|--------------------|--------|--------|--------|--------|--------|------|
|                    | pouces | mm     | pouces | mm     | pouces | mm   |
| 3"                 | 3.00   | 76.20  | 6.00   | 152.40 | 0.078  | 2.00 |
|                    |        |        |        |        | 0.109  | 2.76 |
|                    |        |        |        |        | 0.125  | 3.18 |
| 4"                 | 4.00   | 101.60 | 7.00   | 177.80 | 0.078  | 2.00 |
|                    |        |        |        |        | 0.109  | 2.76 |
|                    |        |        |        |        | 0.125  | 3.18 |
| 6"                 | 6.00   | 152.50 | 9.00   | 139.70 | 0.083  | 2.00 |
|                    |        |        |        |        | 0.109  | 2.76 |
|                    |        |        |        |        | 0.121  | 3.18 |
| 8"                 | 8.00   | 203.20 | 11.00  | 279.40 | 0.078  | 2.00 |
|                    |        |        |        |        | 0.109  | 2.76 |
|                    |        |        |        |        | 0.125  | 3.18 |
| 10"                | 10.00  | 254.00 | 12.00  | 304.80 | 0.078  | 2.00 |
|                    |        |        |        |        | 0.109  | 2.76 |
|                    |        |        |        |        | 0.125  | 3.18 |
| 12"                | 12.00  | 304.80 | 14.00  | 355.60 | 0.078  | 2.00 |
|                    |        |        |        |        | 0.109  | 2.76 |
|                    |        |        |        |        | 0.125  | 3.18 |
| 14"                | 14.00  | 355.60 | 16.00  | 406.40 | 0.109  | 2.76 |
|                    |        |        |        |        | 0.125  | 3.18 |
|                    |        |        |        |        | 0.140  | 3.40 |
| 16"                | 16.00  | 406.40 | 18.00  | 457.20 | 0.109  | 2.76 |
|                    |        |        |        |        | 0.125  | 3.18 |
|                    |        |        |        |        | 0.140  | 3.40 |
| 18"                | 18.00  | 457.20 | 19.00  | 482.60 | 0.109  | 2.76 |
|                    |        |        |        |        | 0.125  | 3.18 |
|                    |        |        |        |        | 0.140  | 3.40 |
| 20"                | 20.00  | 508.00 | 20.00  | 508.00 | 0.125  | 3.18 |
|                    |        |        |        |        | 0.140  | 3.40 |
|                    |        |        |        |        | 0.188  | 4.76 |
| 24"                | 24.00  | 609.60 | 24.00  | 609.60 | 0.250  | 6.35 |
|                    |        |        |        |        | 0.125  | 3.18 |
|                    |        |        |        |        | 0.140  | 3.40 |
| 30"                | 30.00  | 762.00 | 30.00  | 762.00 | 0.188  | 4.76 |
|                    |        |        |        |        | 0.250  | 6.35 |
|                    |        |        |        |        | 0.140  | 3.40 |
| 36"                | 36.00  | 914.40 | 36.00  | 914.40 | 0.140  | 3.40 |
|                    |        |        |        |        | 0.188  | 4.76 |
|                    |        |        |        |        | 0.250  | 6.35 |

# Collets emboutis D.I. (pressed collars)

## ASTM A 774

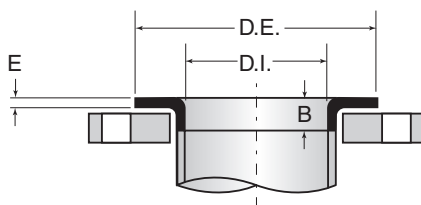

### Bout à souder (butt weld)

| Tuyau dia. nominal |       | D.I.   |       | D.E.   |       | E     | B      |      | Poids approx. |     |
|--------------------|-------|--------|-------|--------|-------|-------|--------|------|---------------|-----|
| pouces             | mm    | pouces | mm    | pouces | mm    | jauge | pouces | mm   | lbs           | kgs |
| 3                  | 76.2  | 3      | 76.2  | 5      | 127.0 | 11    | 11/16  | 17.4 | 0.5           | 0.2 |
| 4                  | 101.6 | 4      | 101.6 | 6 1/2  | 165.1 | 11    | 11/16  | 17.4 | 0.8           | 0.4 |
| 6                  | 152.4 | 6      | 152.4 | 8 1/2  | 215.9 | 11    | 11/16  | 17.4 | 1.2           | 0.5 |

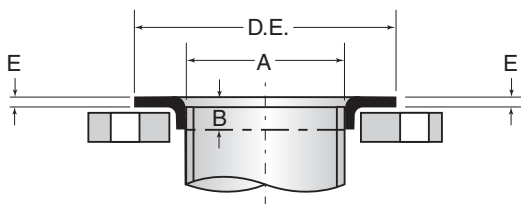

Disponible sur demande

### Coulissant (slip-on)

| Tuyau dia. nominal |       | A      |       | D.E.   |       | E     | B      |      | Poids approx. |     |
|--------------------|-------|--------|-------|--------|-------|-------|--------|------|---------------|-----|
| pouces             | mm    | pouces | mm    | pouces | mm    | jauge | pouces | mm   | lbs           | kgs |
| 3                  | 76.2  | 3 5/16 | 76.2  | 5      | 127.0 | 11    | 11/16  | 17.4 | 0.5           | 0.2 |
| 4                  | 101.6 | 4 5/16 | 101.6 | 6 1/2  | 165.1 | 11    | 11/16  | 17.4 | 0.8           | 0.4 |
| 6                  | 152.4 | 6 5/16 | 152.4 | 8 1/2  | 215.9 | 11    | 11/16  | 17.4 | 1.2           | 0.5 |

Matériau : *Tolérance selon*  
acier inoxydable *ASTM A 774.*  
304L, 316L.

- Autres alliages, diamètres et épaisseurs disponibles sur demande.
- Voir section technique pour pression maximale.

# Collets en cornière D.I.

(Rolled Angle Vanstone) **ASTM A 774**

Matériau :  
acier inoxydable 316L.

Autres alliages disponibles  
sur demande.

Tolérance selon  
ASTM A 774.

Disponible dans  
les mêmes épaisseurs  
que le tuyau.

Collets coulissants fournis  
pour s'ajuster  
au diamètre extérieur  
du tuyau.

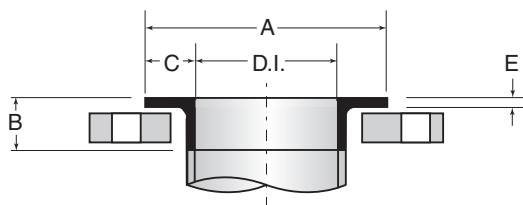

**Bout à souder**  
(butt weld)

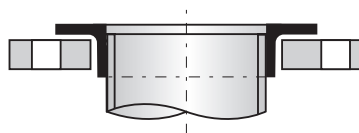

**Coulissant**  
(slip-on)

## Collets en cornière D.I. (Angle collars "vanstone")

| Dia. intérieur |       | A      |        | B-C-E                |                   | Poids approx. |      |
|----------------|-------|--------|--------|----------------------|-------------------|---------------|------|
| pouces         | mm    | pouces | mm     | pouces               | mm                | lbs           | kgs  |
| 3              | 76.2  | 4 1/2  | 114.3  | 3/4 x 3/4 x 1/8      | 19.0 x 19.0 x 3.2 | 0.5           | 0.2  |
| 4              | 101.6 | 6      | 152.4  | 1 x 1 x 1/8          | 25.4 x 25.4 x 3.2 | 0.7           | 0.3  |
| 5              | 127.0 | 7      | 177.8  | 1 x 1 x 1/8          | 25.4 x 25.4 x 3.2 | 1.0           | 0.4  |
| 6              | 152.4 | 8      | 203.2  | 1 x 1 x 1/8          | 25.4 x 25.4 x 3.2 | 1.4           | 0.6  |
| 8              | 203.2 | 10 1/2 | 266.7  | 1 1/4 x 1 1/4 x 1/8  | 31.7 x 31.7 x 3.2 | 2.4           | 0.9  |
| 10             | 254.0 | 13     | 330.2  | 1 1/2 x 1 1/2 x 1/8  | 38.1 x 38.1 x 3.2 | 3.5           | 1.6  |
| 12             | 304.8 | 15     | 381.0  | 1 1/2 x 1 1/2 x 1/8  | 38.1 x 38.1 x 3.2 | 4.1           | 1.9  |
| 14             | 355.6 | 17     | 431.8  | 1 1/2 x 1 1/2 x 1/8  | 38.1 x 38.1 x 3.2 | 4.8           | 2.2  |
| 16             | 406.4 | 19     | 482.6  | 1 1/2 x 1 1/2 x 3/16 | 38.1 x 38.1 x 4.8 | 8.2           | 3.7  |
| 18             | 457.2 | 21     | 533.4  | 1 1/2 x 1 1/2 x 3/16 | 38.1 x 38.1 x 4.8 | 9.0           | 4.1  |
| 20             | 508.0 | 23     | 584.2  | 1 1/2 x 1 1/2 x 3/16 | 38.1 x 38.1 x 4.8 | 10.0          | 4.5  |
| 24             | 609.6 | 28     | 711.2  | 2 x 2 x 1/4          | 50.8 x 50.8 x 6.3 | 21.0          | 9.5  |
| 30             | 762.0 | 34     | 863.6  | 2 x 2 x 1/4          | 50.8 x 50.8 x 6.3 | 25.5          | 11.6 |
| 36             | 914.4 | 40     | 1016.0 | 2 x 2 x 1/4          | 50.8 x 50.8 x 6.3 | 30.5          | 13.8 |

- Autres diamètres et épaisseurs disponibles sur demande.
- Voir section technique pour pression maximale.

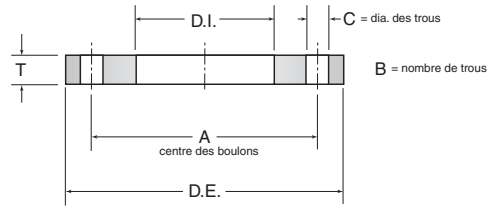
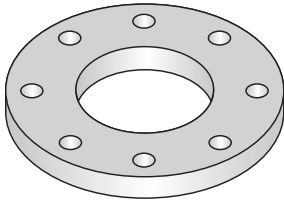

## Brides de retenues D.I. (Backing flanges "rings")

| Tuyau dia. nom. |     | D.E.   |      | D.I.   |     | T1 (épaisseur) |      | T2 (épaisseur) |      | T3 (épaisseur) |      |
|-----------------|-----|--------|------|--------|-----|----------------|------|----------------|------|----------------|------|
| pouces          | mm  | pouces | mm   | pouces | mm  | pouces         | mm   | pouces         | mm   | pouces         | mm   |
| 3               | 76  | 7 1/2  | 191  | 3 5/8  | 92  | 5/8            | 15.9 | 3/4            | 19.0 | 3/4            | 19.0 |
| 4               | 102 | 9      | 229  | 4 5/8  | 117 | 5/8            | 15.9 | 3/4            | 19.0 | 3/4            | 19.0 |
| 5               | 127 | 10     | 254  | 5 5/8  | 143 | 5/8            | 15.9 | 3/4            | 19.0 | 3/4            | 19.0 |
| 6               | 152 | 11     | 279  | 6 5/8  | 168 | 5/8            | 15.9 | 3/4            | 19.0 | 3/4            | 19.0 |
| 8               | 203 | 13 1/2 | 343  | 8 5/8  | 219 | 5/8            | 15.9 | 3/4            | 19.0 | 7/8            | 22.2 |
| 10              | 254 | 16     | 407  | 10 3/4 | 273 | 3/4            | 19.0 | 1              | 25.4 | 1              | 25.4 |
| 12              | 305 | 19     | 483  | 12 3/4 | 324 | 3/4            | 19.0 | 1              | 25.4 | 1 1/4          | 31.7 |
| 14              | 356 | 21     | 534  | 14 3/4 | 375 | 3/4            | 19.0 | 1 1/8          | 28.6 | 1 1/4          | 31.7 |
| 16              | 406 | 23 1/2 | 597  | 16 3/4 | 425 | 3/4            | 19.0 | 1 1/8          | 28.6 | 1 1/2          | 38.1 |
| 18              | 457 | 25     | 635  | 18 3/4 | 476 | 1              | 25.4 | 1 1/4          | 31.7 | 1 1/2          | 38.1 |
| 20              | 508 | 27 1/2 | 699  | 20 7/8 | 530 | 1              | 25.4 | 1 1/4          | 31.7 | 1 5/8          | 41.2 |
| 24              | 610 | 32     | 813  | 24 7/8 | 632 | 1              | 25.4 | 1 3/8          | 34.9 | 2              | 51.0 |
| 30              | 762 | 39     | 985  | 31     | 787 | 1              | 25.4 | 1 1/2          | 38.1 | 2 3/8          | 60.3 |
| 36              | 914 | 46     | 1169 | 37     | 940 | 1              | 25.4 | 1 1/2          | 38.1 | 2 7/8          | 73.0 |

| Tuyau dia. nom. |     | A      |      | B          | C      |      | T1 (poids) |      | T2 (poids) |       | T3 (poids) |       |
|-----------------|-----|--------|------|------------|--------|------|------------|------|------------|-------|------------|-------|
| pouces          | mm  | pouces | mm   | # de trous | pouces | mm   | lbs        | kgs  | lbs        | kgs   | lbs        | kgs   |
| 3               | 76  | 6      | 152  | 4          | 3/4    | 19.0 | 5.9        | 2.7  | 7.1        | 3.2   | 7.1        | 3.2   |
| 4               | 102 | 7 1/2  | 190  | 8          | 3/4    | 19.0 | 7.9        | 3.6  | 9.5        | 4.3   | 9.5        | 4.3   |
| 5               | 127 | 8 1/2  | 216  | 8          | 7/8    | 22.2 | 8.9        | 4.0  | 10.7       | 4.9   | 10.7       | 4.9   |
| 6               | 152 | 9 1/2  | 241  | 8          | 7/8    | 22.2 | 10.3       | 4.7  | 12.3       | 5.6   | 12.3       | 5.6   |
| 8               | 203 | 11 3/4 | 298  | 8          | 7/8    | 22.2 | 14.7       | 6.7  | 17.7       | 8.0   | 20.6       | 9.4   |
| 10              | 254 | 14 1/4 | 362  | 12         | 1      | 25.4 | 18.9       | 8.6  | 30.2       | 13.7  | 30.2       | 13.7  |
| 12              | 305 | 17     | 432  | 12         | 1      | 25.4 | 32.7       | 14.8 | 43.5       | 19.7  | 54.4       | 24.7  |
| 14              | 356 | 18 3/4 | 476  | 12         | 1 1/8  | 28.6 | 36.6       | 16.6 | 55.0       | 25.0  | 78.6       | 35.7  |
| 16              | 406 | 21 1/4 | 540  | 16         | 1 1/8  | 28.6 | 44.0       | 20.0 | 66.0       | 29.9  | 88.3       | 40.1  |
| 18              | 457 | 22 3/4 | 578  | 16         | 1 1/4  | 31.7 | 48.8       | 22.1 | 81.4       | 36.9  | 97.6       | 44.4  |
| 20              | 508 | 25     | 635  | 20         | 1 1/4  | 31.7 | 69.0       | 31.3 | 86.3       | 39.1  | 112.0      | 50.9  |
| 24              | 610 | 29 1/2 | 749  | 20         | 1 3/8  | 34.9 | 88.0       | 39.9 | 121.0      | 44.9  | 176.0      | 80.2  |
| 30              | 762 | 36     | 914  | 28         | 1 3/8  | 34.9 | 117.0      | 53.1 | 176.0      | 79.8  | 279.0      | 126.7 |
| 36              | 914 | 42 3/4 | 1086 | 32         | 1 5/8  | 41.3 | 158.0      | 71.7 | 237.0      | 107.5 | 454.0      | 206.5 |

*(poids approximatif)*

- **Matériau :** T1, T2=acier doux. T3=A516Gr.70.
- **Perçage :** ASME B16,5 CL.150
- **Note :** T3 sur demande seulement.
- **Fini :** galvanisé
- **Pression maximale :** Voir section technique.

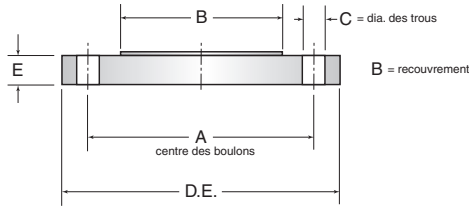
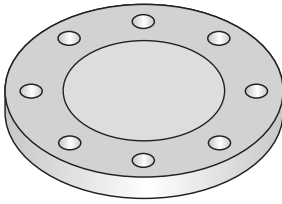

## Brides pleines D.I. (blind flanges)

| Tuyau dia. nom. |     | D.E.   |      | A      |      | B      |        |
|-----------------|-----|--------|------|--------|------|--------|--------|
| pouces          | mm  | pouces | mm   | pouces | mm   | pouces | mm     |
| 3               | 76  | 7 1/2  | 191  | 6      | 152  | 4 1/2  | 114.3  |
| 4               | 102 | 9      | 229  | 7 1/2  | 190  | 6      | 152.4  |
| 5               | 127 | 10     | 254  | 8 1/2  | 215  | 7      | 177.8  |
| 6               | 152 | 11     | 279  | 9 1/2  | 241  | 8      | 203.2  |
| 8               | 203 | 13 1/2 | 343  | 11 3/4 | 298  | 10 1/2 | 266.7  |
| 10              | 254 | 16     | 407  | 14 1/4 | 362  | 13     | 330.2  |
| 12              | 305 | 19     | 483  | 17     | 432  | 15     | 381.0  |
| 14              | 356 | 21     | 534  | 18 3/4 | 476  | 17     | 431.8  |
| 16              | 406 | 23 1/2 | 597  | 21 1/4 | 540  | 19     | 482.6  |
| 18              | 457 | 25     | 635  | 22 3/4 | 578  | 21     | 533.4  |
| 20              | 508 | 27 1/2 | 699  | 25     | 635  | 23     | 584.2  |
| 24              | 610 | 32     | 813  | 29 1/2 | 749  | 28     | 711.2  |
| 30              | 762 | 38 3/4 | 985  | 36     | 914  | 34     | 863.6  |
| 36              | 914 | 46     | 1169 | 42 3/4 | 1086 | 40     | 1016.0 |

| Tuyau dia. nom. |     | E      |      | nombre de trous | C      |      | poids approx. |       |
|-----------------|-----|--------|------|-----------------|--------|------|---------------|-------|
| pouces          | mm  | pouces | mm   |                 | pouces | mm   | lbs           | kgs   |
| 3               | 76  | 3/4    | 19.0 | 4               | 3/4    | 19.0 | 9.8           | 4.5   |
| 4               | 102 | 3/4    | 19.0 | 8               | 3/4    | 19.0 | 14.0          | 6.4   |
| 5               | 127 | 3/4    | 19.0 | 8               | 7/8    | 22.2 | 17.6          | 8.0   |
| 6               | 152 | 3/4    | 19.0 | 8               | 7/8    | 22.2 | 21.3          | 9.7   |
| 8               | 203 | 3/4    | 19.0 | 8               | 7/8    | 22.2 | 32.2          | 14.6  |
| 10              | 254 | 1      | 25.4 | 12              | 1      | 25.4 | 58.0          | 26.5  |
| 12              | 305 | 1      | 25.4 | 12              | 1      | 25.4 | 83.1          | 37.8  |
| 14              | 356 | 1 1/8  | 28.6 | 12              | 1 1/8  | 28.6 | 113.0         | 51.4  |
| 16              | 406 | 1 1/8  | 28.6 | 16              | 1 1/8  | 28.6 | 142.0         | 64.5  |
| 18              | 457 | 1 1/4  | 31.7 | 16              | 1 1/4  | 31.7 | 179.0         | 81.4  |
| 20              | 508 | 1 1/4  | 31.7 | 20              | 1 1/4  | 31.7 | 217.5         | 98.9  |
| 24              | 610 | 1 3/8  | 34.9 | 20              | 1 3/8  | 34.9 | 323.0         | 146.8 |
| 30              | 762 | 1 1/2  | 38.1 | 28              | 1 3/8  | 34.9 | 530.0         | 240.4 |
| 36              | 914 | 1 1/2  | 38.1 | 32              | 1 5/8  | 41.3 | 755.0         | 342.5 |

- **Matériau :** Acier doux avec recouvrement de 316L.
- **Perçage :** ASME B16,5 CL.150
- **Fini :** galvanisé
- **Pression maximale :** Voir section technique